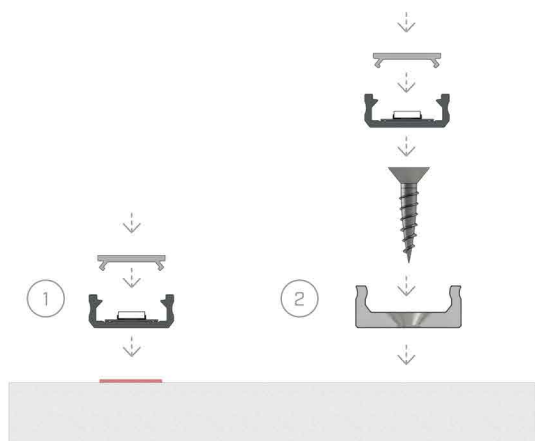
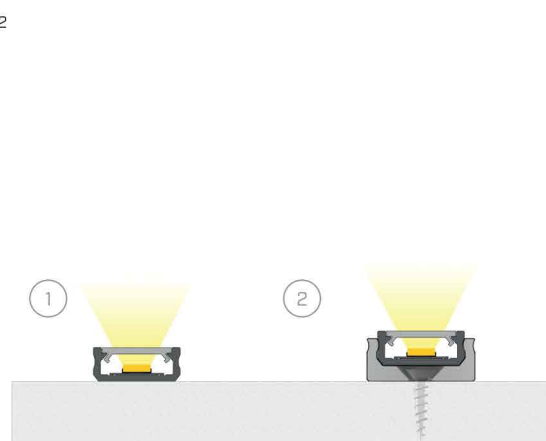

fig. 1



Installation instructions for profile D with a BASIC cover using
 (1) double-sided tape, (2) a MINI mounting clip and screw

fig. 2



The end result of installation of profile D with a BASIC cover using
 (1) double-sided tape, (2) a MINI mounting clip and screw

fig. 3

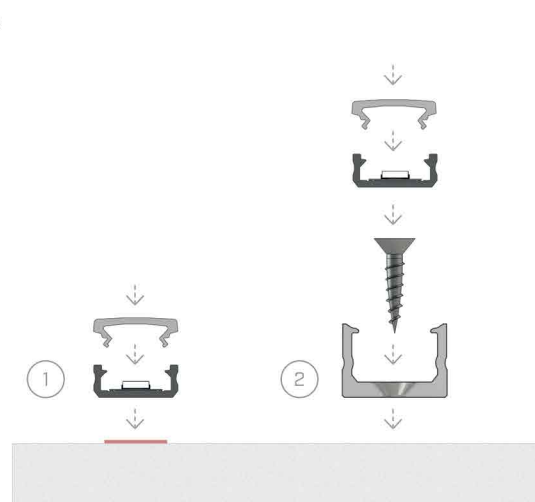

Installation instructions for profile D with a HIGH cover using
 (1) double-sided tape, (2) a mounting clip and screw

fig. 4

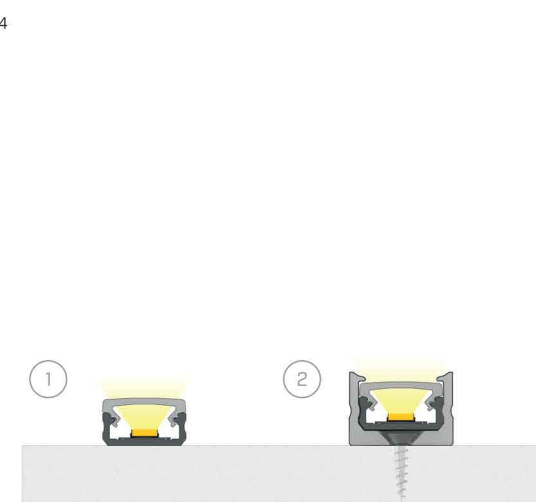

The end result of installation of profile D with a HIGH cover using
 (1) double-sided tape, (2) a mounting clip and screw

fig. 5

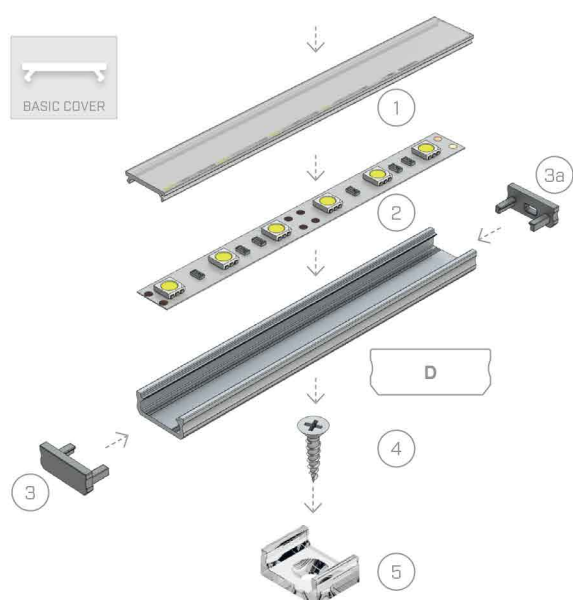

Assembly scheme for elements of the lighting system using profile D
 and (1) BASIC cover, (2) LED strip (3) end cap without hole, (3a) end cap
 with hole, (4) screw, (5) MINI mounting clip for profile D

fig. 6

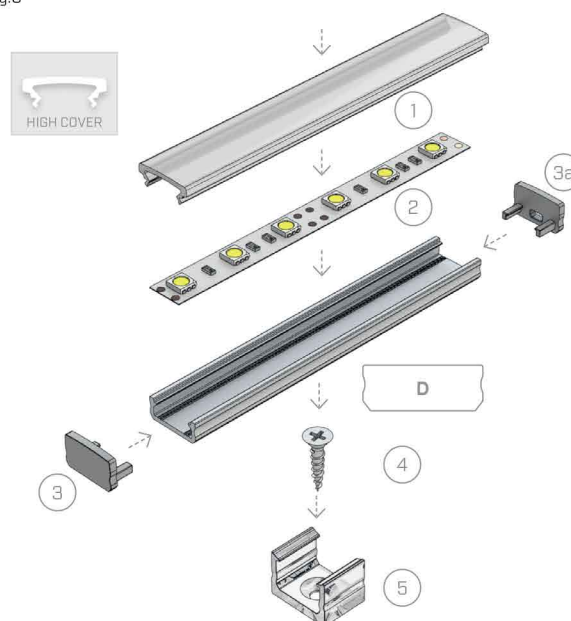

Assembly scheme for elements of the lighting system using profile D
 and (1) a HIGH cover, (2) LED strip, (3) end caps without hole,
 (3a) end caps with hole, (4) screw, (5) mounting clip for profile D
 with HIGH cover