

# LED ALUMINIUM PROFILES & EXTRUSIONS



DATA SHEET

LED PROFILE

OIPO

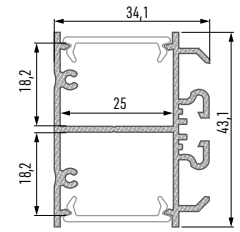

## PROFILE OIPO

	White (lacquered)	Silver (anodized)
Dimensions	1000mm, 2020mm, 3000mm	
LED strip width	4 x 12mm	
Application	Two-side surface mounted profile - for the purpose of lighting office spaces, open space areas and in the field of engineering construction sector	

### Covers (PMMA)

Dimensions: 1000mm, 2020mm, 3000mm

Transparent	Frozen	Milky	Frosted	Milky Frosted
<b>DOUBLE</b>				
✪ PMMA 93%	✪ PMMA 79%	✪ PMMA 50%	✪ PMMA 85%	✪ PMMA 82%

### End caps for LED profile OIPO (aluminium)

With a hole		Without a hole	
White	Silver	White	Silver

### Accessories

Straight connector	Angular connector 90°	Angular transverse connector 90°	Angular connector 120°
Mounting profile AILA M1	Cable gland	Pendants	

Maximum dissipated power of LED light sources for temperature profile 55°C: 44.8W. For temperature profile 65°C: 67.2W.