

# LED ALUMINIUM PROFILES & EXTRUSIONS



DATA SHEET

LED PROFILE

**OCIN**

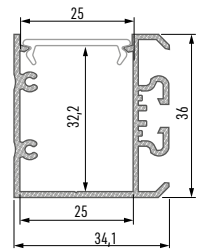

## PROFILE OCIN

	White (lacquered)	Silver (anodized)
Dimensions	1000mm, 2020mm, 3000mm	
LED strip width	2 x 12mm	
Application	One-side surface profile - for the purpose of directional lighting like wallwasher effect inside the public utility premises and office spaces	

### Covers (PMMA)

Dimensions: 1000mm, 2020mm, 3000mm

Transparent	Frozen	Milky	Frosted	Milky Frosted
<b>DOUBLE</b>				
± DMMA 93%	± DMMA 79%	± DMMA 50%	± DMMA 85%	± DMMA 82%

### End caps for LED profile OCIN (aluminium)

With a hole				Without a hole			
White		Silver		White		Silver	
Left	Right	Left	Right	Left	Right	Left	Right

### Accessories

<p>Straight connector</p>	<p>Angular connector 90°</p>	<p>Angular transverse connector 90°</p>	<p>Angular connector 120°</p>
<p>Mounting profile AILA M1</p>	<p>Cable gland</p>	<p>Pendants</p>	

Maximum dissipated power of LED light sources for temperature profile 55°C: 42W. For temperature profile 65°C: 56W.