

Smart Control 7

Safety instructions



Electrical devices may only be mounted and connected by electrically skilled persons.

Serious injuries, fire or property damage possible. Please read and follow manual fully.

Danger of electric shock. Always disconnect before carrying out work on the device or load.

These instructions are an integral part of the product, and must remain with the end customer.

Structure of the device

- (1) Locking screw
- (2) Holding magnet
- (3) Design cover
- (4) Smart Control

Function

Intended purpose

- Operation and visualisation of system statuses and information on building automation
- for installation in walls

Product characteristics

- Door call function only in combination with Siedle Smart Gateway SG 650-.. or SG 150-..
- KNX visualisation in combination with Visu Pro Server (ref.-no.: JVP-SERVER-H..)
- KNX visualization in combination with Smart Visu Server (ref.-no.: SV-SERVER-INT)
- Pre-installed iHaus-Server-App; iHaus-KNX connection via IP router (ref.-no.: IPR 200 REG, IPR 300 SREG) or IP interface (ref.-no.: IPS 200 REG, IPS 300 SREG)
- eNet visualisation in combination with eNet server for rail mounting (ref.-no.: ENET-SERVER) with software version 2.0 or higher. Only vertical installation possible.
- Pre-installed weather page
- Display of up to six IP camera images
- Cleaning function
- Capacitive touchscreen
- Fanless, without rotating parts
- Graphical user interface

Information for electrically skilled persons

Installation and electrical connection



DANGER
Electric shock from touching live parts in the installation environment.
An electric shock can be fatal.
Before working on the device, disconnect the power and cover live parts in the area.

The Smart Control must be installed in the flush-mounted recessed box SC 7 EBG.

Ensure correct orientation when installing the flush-mounted box:

- without eNet visualisation: vertical or horizontal
- with eNet visualisation: vertical

The flush-mounted box must be exactly orientated in the wall.

- Screw in holding magnet (2) on the rear side of Smart Control (4).

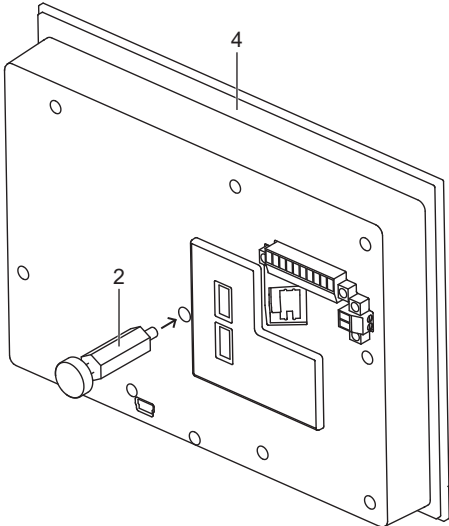

- Connect LAN (PoE+).
- Connect optional power supply.
- Place Smart Control in flush-mounted box. For optimal position adjust magnet. Screw or unscrew head of magnet to adjust it.

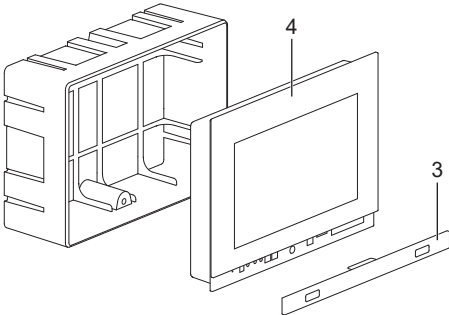

- Tighten locking screw (1) under design cover (3).

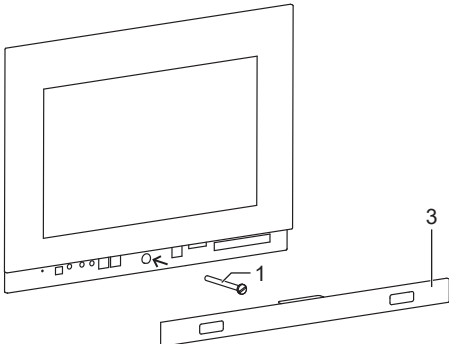

- Attach design cover.

Comissioning

After connecting the device you must change the default settings for comissioning your device.

Settings – Menu overview

- General / Design settings
 - Language
 - Time / Date
- Power / Lock screen settings
- System / Access settings
 - Password protection

Opening the settings menu

- Select JUNG-logo in main menu (JUNG Launcher). Password input opens.
- Enter password. The default password is “0000”. Settings menu opens.

Changing the default language

- Open settings menu.
- Select menu “General / Design settings”.
- Select submenu “Language”.
- Choose “Select language”. Available languages are shown.
- Select language. Default language is changed.

Selecting the current date and time

- Open settings menu.
- Select menu “General / Design settings”.
- Select submenu “Date / Time”.
- Change settings:
 - autom. date & time: activated
 - autom. time zone: deactivated
 - Select time zone (e.g. GMT+2)
 - 24-hour format: activated

Changing the default password

- Open settings menu.
- Select menu “System / Access settings”.
- Select submenu “Password protection”. Password input opens.
- Enter current and new password. To continue without password protection, don't enter new password.
- Confirm passwords with “OK”. Default password is changed.

Creating app shortcut in main menu

- Touch and hold area/tile in main menu. Google Play request opens.
- Cancel request. App list is shown.
- Select app. Request for symbol and name opens.
- Change symbol and name or use default settings. App shortcut is shown in main menu.

Updating the firmware

Requirement: Internet connection

Requirement: App “System Update” in main menu

- Select app “System Update”. App starts.
- Select „Check online for updates”. Firmware is updating automatically.

Operation

The device is operated by preinstalled apps.

The apps must be started via main menu.

For detailed information about operation and configuration of the device please see the product documentation. The product documentation can be downloaded from our website.

Cleaning

-  The cleaning mode must be started with „Screen-cleaner” app.

Suitable detergents:

Water, degreaser, glass cleaner, alcohol and iso-propyl

Not suitable detergents:

Abrasive wipes or aggressive detergents

- Start cleaning mode or switch off device to lock touchscreen.
- Apply detergent or water on a cleaning wipe. Don't apply it directly on device.

Smart Control 7

Ref.-no.: SC 7.1 AL, SC 7.1 SW

Quick guide

ALBRECHT JUNG GMBH & CO. KG

Volmestraße 1
58579 Schalksmühle
GERMANY

Tel. +49 2355 806-0
Fax +49 2355 806-204
kundencenter@jung.de
www.jung.de

- Clean front side with wipe. Detergent is not allowed to get into the device while cleaning.
- Switch on device after cleaning it or wait until automatic end of cleaning mode after 30 seconds.

Technical data

Screen diagonal	178 mm / 7.0"
Resolution	1024 x 600 WSVGA
Frame dimensions (W x H)	206 x 150 mm
Power consumption	max. 7 W
Power supply	

Power over Ethernet Plus (PoE+) acc. to IEEE 802.3at or DC 12 ... 32 V via external power supply

Aspect ratio	16:9
Operating system	Android 6
Processor	Cortex-A53
Main memory	2 GB
Mass storage	16 GB Flash
Ambient temperature	0 ... +30 °C

Accessories

Power supply	NT 2415 REG VDC
Flush-mounted recessed box	SC 7 EBG

Warranty

The warranty follows about the specialty store in between the legal framework as provided for by law.